

Mounting of a HP VELOTECHNIK Universal Mount TopView



Fig 1 Mounted TopView holder with additional mobile phone holder and mobile phone

Description

The universal holder is a device to attach accessories such as a mobile phone holder, GPS or bell. It is mounted on a handlebar for under seat steering with a barend shifter. No other attachments should be mounted to the barend shifter.

These instructions describe the installation with barend shifters currently used by HPVELOTECHNIK: SRAM SL-500, MICROSHIFT BS 09, STURMEY ARCHER HSJ 963.

The max. payload on the universal holder is 400 g (0,88 lbs). The assembly can be carried out by a consumer.

Content

- 1 adapter for barend shifter
- 1 clamp (flexed, preassembled)
- 1 holder tube (tube diameter 22,2 mm)
- 3 barend caps
- 2 socket head screws M3 x14
- 1 countersunk screw M6 x16

Mounting on a barend shifter SRAM SL-500

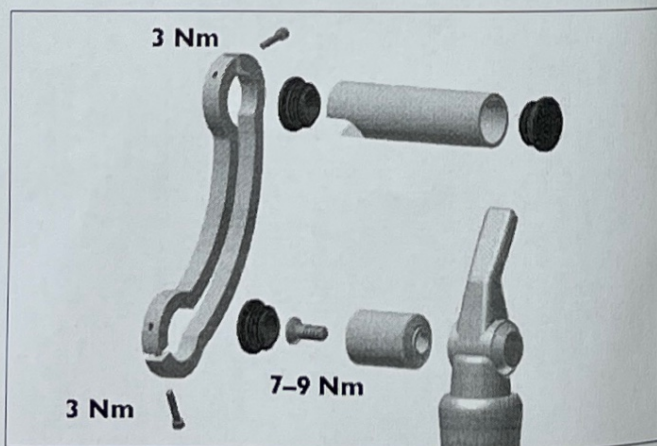

Fig 2 Mounting on a barend shifter SRAM SL-500

1. Remove the mounting screw of the barend shifter.
2. Use the longer countersunk screw (M6x16) to mount the adapter to the barend shifter (torque 7–9 Nm).
3. Slide the clamp with one end onto the adapter with the other end onto the holder tube and tighten the clamping screws to a torque of 3 Nm.
4. Close the adapter and the holder tube with the 3 barend caps.

Mounting on a barend shifter MICROSHIFT BS 09 or STURMEY ARCHER HSJ 963

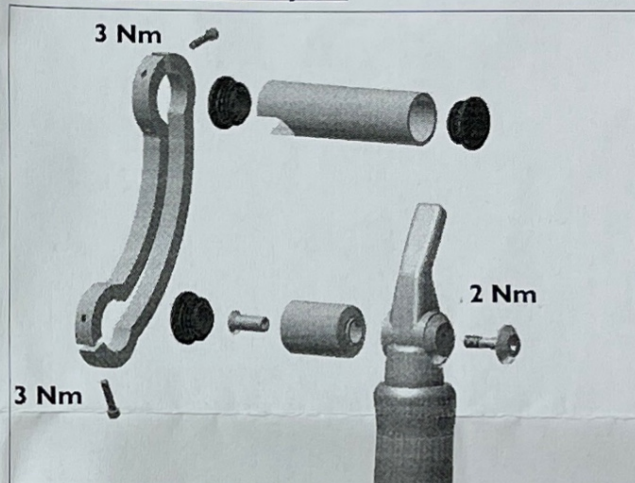

Fig 3 Mounting on a barend shifter MICROSHIFT BS 09 or STURMEY ARCHER HSJ 963

1. Loosen the fixing screw and sleeve nut of the handlebar shift lever.
2. Insert the sleeve nut through the adapter and retighten the sleeve nut and fixing screw (torque 2 Nm).
3. Slide the clamp with one end onto the adapter with the other end onto the holder tube and tighten the clamping screws to a torque of 3 Nm.
4. Close the adapter and the holder tube with the 3 barend caps.

You can now attach your desired accessories to the holder tube, note the maximum payload of 400 g (0,88 lbs).